



MODEL SEMI TRAYSEALER

MODELS - DUO 1000 DUO 2000 DUO 1000V DUO 2000V

WITH VACUUM PUMP

TECSELOR, S. L.
 Poligono Industrial de Lorca, Buzón 180
 Avda. Manuel Mtnez. Barea, Parc. M7/M14
 30817 Lorca - Murcia - Spain
 Office Phone. +34 968 476 368
 Fax. +34 968 109 204
 Technical Assistance. +34 678 424 587
 Email: frimaq@frimaq.com

AISI 304 STAINLESS STEEL STRUCTURE.
 DIGITAL PLATE AND VACUUM.
 VACUUM BY PERCENTAGE, TIME OR BOTH.
 GAS INJECTION BY PERCENTAGE AND RISING GAS TIME.
 TEMPERATURE CONTROL BY PROBE AND P.I.D. CONTROL.
 100 m³/h BUSCH VACUUM PUMP. 2 100 m³/h BUSCH VACUUM PUMP FOR "V" MODELS.
 1 TRAY CAPACITY OF 1/2 GN IN EACH CHAMBER.
 2 TRAYS CAPACITY OF 1/4 GN IN EACH CHAMBER.

DRAG OF FILM BY SINCRONIZED MOTORS.
 CUSTOMERS ADAPTATION OF MOLDS WANTED.
 REPLACEABLE RINGS TO ADAPT THE TRAYS OF ANY CUSTOMER.
 ADVANCE FILM MODES: BY LENGHT-BY A PRINTING SIGN.
 EASY MECHANICAL, ELECTRICAL AND PNEUMATICAL MAINTENANCE.
 POWER: 6 KW (8 KW FOR "V" SERIE).



LOADING ZONE



LEFT DRAWER

RIGHT DRAWER

GAS MOLDS

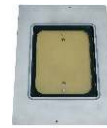

1/2 GN MOLD

CODE: 3567 €



1/4 GN MOLD

CODE: 3542 €



1/6 GN MOLD

CODE: 3573 €

THE DIFFERENCE BETWEEN NORMAL AND "V" MODELS IS "V" ONE HAS 2 VACUUM PUMPS, GAS INJECTION TANK AND DOES 1,5 CYCLES MORE PER MINUTE.

MODELS

- DUO 1000** 1 DRAWER WITH A 100 M³/H BUSCH PUMP. (OXYGEN + €)
- DUO 2000** 2 DRAWER WITH A 100 M³/H BUSCH PUMP. (OXYGEN + €)
- DUO 1000-V** 1 DRAWER WITH 2 100 M³/H BUSCH PUMPS. (OXYGEN + €)
- DUO 2000-V** 2 DRAWER WITH 2 100 M³/H BUSCH PUMPS. (OXYGEN + €)

SPECIAL OXYGEN PUMP

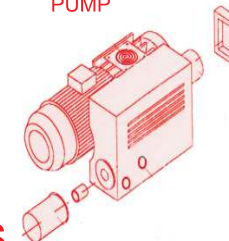

V.A.T. NOT INCLUDED IN THE PRICES

WWW.FRIMAQ.COM
 IND.REG.Nº.: 30/29439

TECSELOR, S. L.
 Poligono Industrial de Lorca, Buzón 36
 Avda. José Montoya García, Parcel G-12
 30817 Lorca - Murcia - Spain
 Office Phone. +34 968 476 368
 Fax. +34 968 109 204
 Technical Assistance. +34 678 424 587
 Email: frimaq@frimaq.com
 Email: frimaq_maquinaria@yahoo.es