



WWW.FRIMAQ.COM  
v.3.3

CE

# THERMOFORMING DOUBLE SEALED STATION

FILM WIDTH FROM 100 A 670 mm. ANY MEASURE  
ADVANCES FROM 0 mm a 1000 mm ANY MEASURE

## FILM

CRYOVAC  
BEMIS  
KLOCKNER - PENTAPLAST  
WIPAK  
C.F.S.  
ETC.

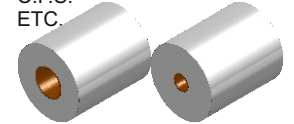

5 SYSTEMS

- \*FLEXIBLE
- \*RIGID MAX 1200 MICRON
- \*LEVEL SKIN
- \*SUPERIOR SKIN 20 mm
- \*SHRINK

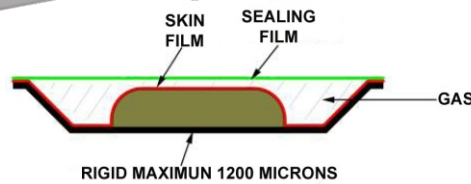
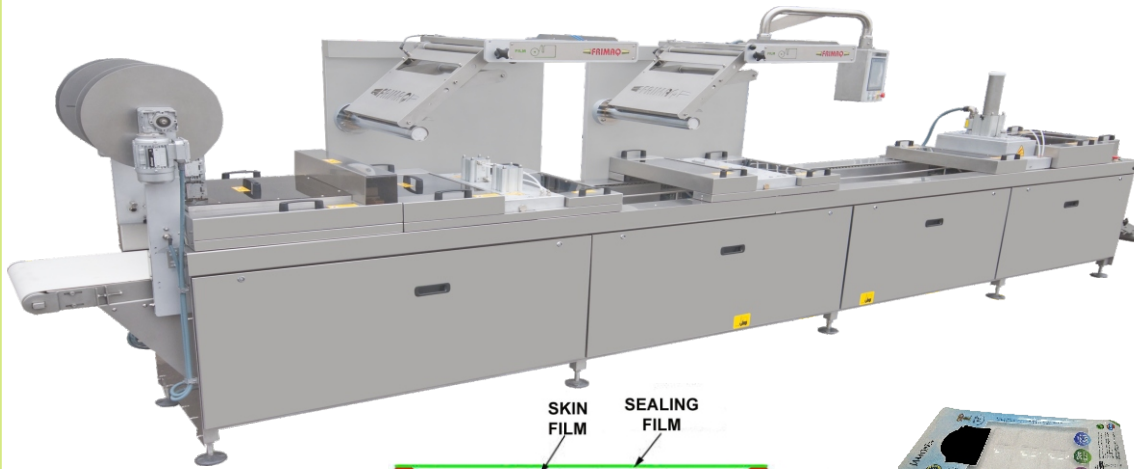

## GENERAL FEATURES

COLOR TOUCHSCREEN 10" ROTATING  
39 PROGRAMS FOR DIFFERENT PRODUCTS PACKAGING.  
SEVERAL ALARMS TO INDICATE ANY INCEDENCE.  
CONNECTIONS FOR PRINTERS, DISPENSERS, ETC.  
START AND STOP CHAIN NORMAL, SOFT AND VERY SOFT FOR LIQUIDS.  
PROGRESS X1, X2, X3 AND ASYMMETRIC.  
ANTI-CONDENSATION RESISTANCE IN ELECTRICAL PANEL.  
CORRECT CONTAINERS COUNTER TO SIGHT.  
NEGATIVE COUNTER FOR BAD PACKAGING TO SIGHT.  
CYCLES PER MINUTE SPEED TO SIGHT.  
MENU FOR OPERATOR.  
MENU FOR MAINTENANCE OFFICER.  
CHAIN PROGRESS WITH 70 DIFERENTS SPEED.  
SELECTION OF THE NUMBER OF PROGRESS BY RUN PULSE.  
BUTTON FOR MANUAL INPUT OF BOTTOM FILM OR CONTINUOUS PULSE.  
SCRAPS BREAK INDICATOR  
VACUUM TEST  
END OF CYCLE BY CONTAINER OR PROGRESS  
MAIN SWITCH AND IDENTIFICATION OF CABLES CE STANDARDS  
NICKEL CHAINS WITH STAINLESS STEEL CLAMPS AND SPRINGS  
CHAIN DRIVE BY HIGH PERFORMANCE SERVO-MOTOR  
MAXIMUM DIAMETER OF TOP ROLL 350 mm (STANDARD).  
BOTTOM ROLL DIAMETER 400 mm (STANDARD).  
ROLL HOLDER ADAPTED TO CORE 76 mm 3".  
TOP AND BOTTOM ROLL HOLDER WITH BRAKE AND TENSION ARM.  
TOP AND BOTTOM ROLL HOLDER WITH LATERAL ADJUST.  
DIRECT VACUUM AT CONTAINER.  
VACUUM BY MILIBARS, TIME AND INTERMITTENT PROGRESSION  
WELDING CYLINDER ACTUATED WITH AIR PRESSURE + VACUUM.  
PERIMETER WELD FOR HEAT NO PRODUCT.  
EASY OPEN IN CONTAINER IN THE PLACE TO BE DETERMINED.  
FRAME - GRILLED WELDING WITH EASY CHANGE DRAWER  
ADJUSTABLE EXIT ROLLER RAMP FOR CONTAINER.  
SEPARATE AND CONTROLLED VENTILATION AT VACUUM AND FORMED DIES.  
MOTORIZED PULLEYS FOR REMMANTS EVACUATION  
SCRAPS SPROCKETS CLEANERS CAUGHT IN THE CHAIN OF RETURN.  
SUPPLEMENTS FOR DIFFERENT HEIGHTS OF FORMING CONTAINERS.  
TRANSVERSAL CUT.  
LONGITUDINAL CUT.  
THERMOFORMED BY COMPRESSED AIR.  
EASY MOLD CHANGE.  
LOADING ZONE WITH LONGITUDINAL SUPPORT FOR LIGHT CONTAINERS.  
STAINLESS STEEL FRAME WITH ROBUST DESIGN HYGIENE.  
SIDE DOOR FOR EASY ACCESS FOR MAINTENANCE.  
LEVEL AND HEIGHT SETTING FOOT OF THE MACHINE.  
COOLING BY NETWORK WATER.  
WATER SYSTEM WITH DRAIN VALVE FOR CHANGING THE MOLD.  
COPPER DEPOSIT WITH PRESSURE AIR RESERVE.  
DIES ELEVATION FOR LEVERS OPERATED BY CYLINDER.  
DESIGN FOR QUICK AND EASY MAINTENANCE.  
WATERPROOF STAINLESS STEEL CABINET FOR ELECTRICAL / PNEUMATIC.  
SECURITY GUARDS CE STANDARDS.  
DIES GUARDS STAINLESS STEEL AND METHACRYLATE  
MAXIMUM HEIGHT OF STANDARD THERMOFORMING 120 mm.  
IMPURITIES FILTER BEFORE ELECTRO VALVE.  
ANTI HIT SHOCK IN DIES FOR HIGH SPEED.  
NOISE SILENCER COMPRESSED AIR.  
AIR CLEANING FILTER IN FORMED  
DIES CLOSING SET BY REGULATORS

## OPTIONAL FEATURES

- \* END OF FILM DETECTOR UPPER AND LOWER
- \* REMOTE CONTROL VIA INTERNET WITH VIDEO OR WITHOUT VIDEO
- \* CLEAN PROGRAM CLOSING DIES
- \* CENTERING PHOTOCELL FILM PRINT TOP AND BOTTOM
- \* ADJUSTMENT FOR SKIN (+0) OR (+20) PACKAGING.
- \* ADJUSTMENT FOR SHRINKABLE FILM WITH DIE LIFT
- \* VACUUM AND GAS BY CANNULAS.
- \* MULTIPURPOSE WELDING PLATE.
- \* OUTPUT TAPE MOTORIZED AND ADJUSTABLE WITH / WITHOUT WHEEL
- \* PRE-HEATING STATION BEFORE FORMING.
- \* DIE WITH MECHANISM HELP TO FORM WITH AN EVEN THICKNESS.
- \* THERMOFORMING BY EXPLOSION, VACUUM OR PRESSURE + VACUUM
- \* EUROSLOT IN CONTAINERS.
- \* TRANSVERSE OR LONGITUDINAL MICRO CUTS
- \* AUTO GREASE BY BLOW
- \* FLUID DECANTER BEFORE PUMP.
- \* SPECIAL THERMOFORMED HEIGHT TO 200 mm.
- \* DIFFERENT PROGRESS POSSIBILITY IN THE SAME MACHINE
- \* LOADING ZONE WITH LONGITUDINAL SUPPORT FOR HEAVY CONTAINERS.
- \* ROUNDED EDGE IN RIGID PACKAGING FILM.
- \* DOUBLE COLUMN ELEVATION IN LONG ADVANCES.
- \* FRACTIONABLE CHASSIS BY SEGMENT.
- \* DOUBLE SEALED STATION.
- \* EASY-OPEN SKIN
- \* TRUCK PULLER FOR LARGE DIE
- \* WATER COOLER CIRCUIT 2500 Kcal / h 4.5 KW
- \* JUMBO REEL HOLDER Ø700 O Ø1000 1 or 2 COILS
- \* BENCH FOR OUTDOOR PUMP
- \* ADAPTED TO CORE 150 mm 6"
- \* WHEELS FOR EASY TRANSPORTATION
- \* HINGE OVERHEAD DIE
- \* LASER CUTTING POWER 200W or 300W.
- \* SLIDE FOR LARGE DIES.
- \* REMMANT PICK BY ASPIRATOR.
- \* FLAP IN CONTAINERS.
- \* SUPPORT FOR HEAVY CONTAINERS.
- \* PRINTERS AND LABELING.
- \* MICROPERFORATED TOP FILM FOR AGRICULTURAL PRODUCTOS.
- \* ENGRAVINGS IN CONTAINERS FUNDS.
- \* SUPPORT FOR HEAVY CONTAINERS IN VACUUM DIES.
- \* INCORPORATED REMMANT DESTROYER

## TECHNICAL FEATURES

- \* TOTAL APPROXIMATE WIDTH 930mm.
- \* TOTAL LENGTH DEPENDS ON PROGRESS AND AREAS OF CHARGE.
- \* TOTAL HEIGHT FROM 1700 TO 1800mm. WITH ADJUSTABLE LEGS.
- \* TOTAL WEIGHT APPROX 1400 KG. DEPENDS ON EQUIPMENT.
- \* AREAS OF CHARGE TO CHOOSE THE NUMBER OF CYCLES.
- \* WIRING (5 PINS) - (3 Phases + N + T).
- \* ELECTRIC POWER MAX. BY EQUIPMENT.
- \* VACUUM PUMP VOLUME m<sup>3</sup> / hour.
- \* WIDTH OF TOP FILM BY MODEL.
- \* WIDTH OF BOTTOM FILM BY MODEL.
- \* ADVANCE FILM AS MODEL.